

Konfigurasi Microsoft Outlook Mac

1. Open Microsoft Outlook.app

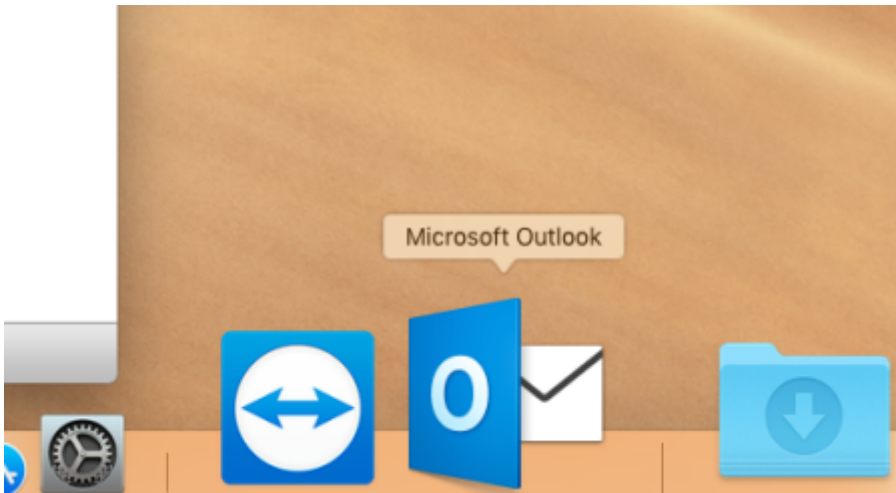

- Isikan Email anda
- Continue

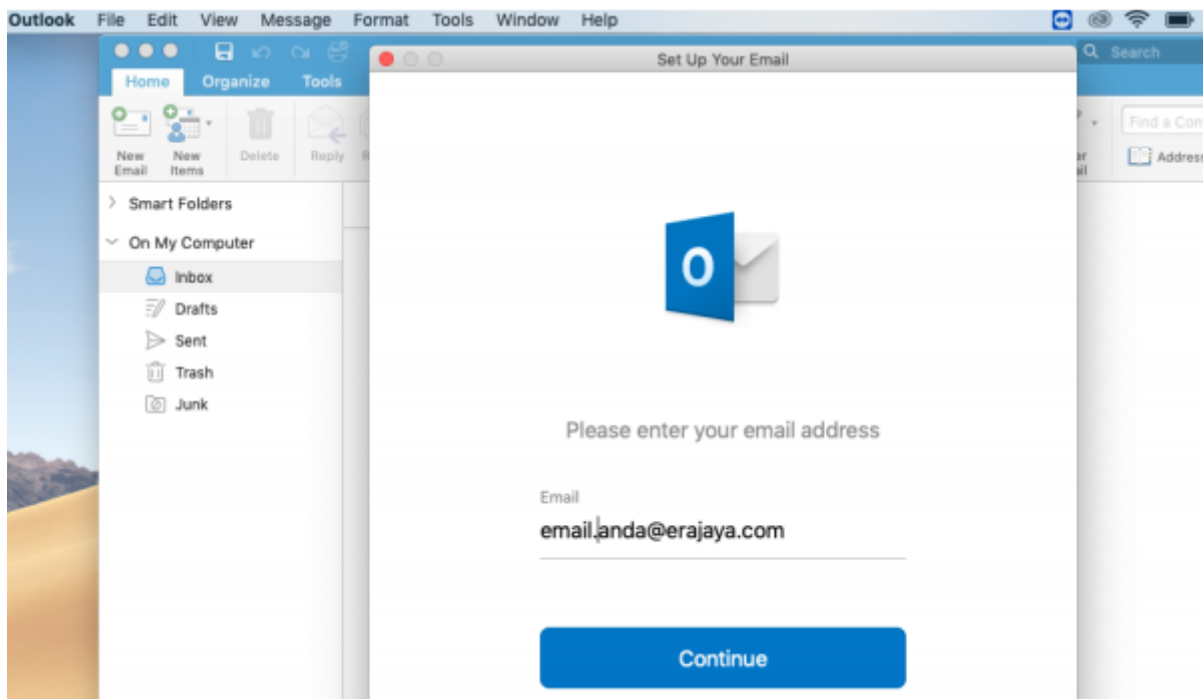

- Pilih IMAP/POP

email.anda@erajaya.com



Office365



Outlook.com



Exchange



Gmail



iCloud



Yahoo!



IMAP/POP

- Pilih POP

2. Selanjutnya Isikan sesuai dengan penjelasan pada konfigurasi Apple Mail

- Klik Add Account



[Not IMAP/POP?](#)



IMAP/POP

Type

POP



Email Address

email.anda@erajaya.com

Username

email.anda@erajaya.com

Password

●●●●●●●●●●

☐ Show Password

Incoming Server

Port

mail.erajaya.com

995

☒ Use SSL to connect (recommended)

Outgoing Server

Port

mail.erajaya.com

465

☒ Use SSL to connect (recommended)

Add Account

Revision #1

Created Thu, Jan 28, 2021 2:39 PM by [Admin](#)

Updated Thu, Jan 28, 2021 2:44 PM by [Admin](#)